

# GOTHARD INDUSTRIAL PARK

## Industrial Units Available from 540 - 3,750 S.F.



**17202 Gothard Street ■ HUNTINGTON BEACH, CA**

### FEATURES

- Office/Warehouse Units
- 10' x 10' Overhead Doors
- Excellent Freeway Access
- Owner Owns and Manages Several Other Business Parks in the Area
- No CAM Fees

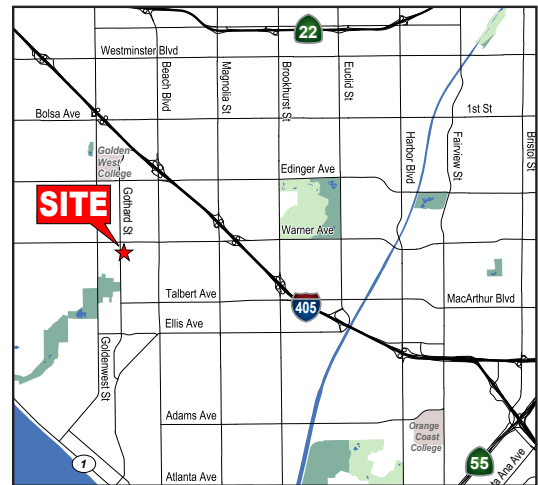

For further information, please contact:

151 Kalmus Drive, Suite F-2  
Costa Mesa, CA 92626  
714.641.1130 main  
714.641.4833 fax



The information contained herein has been obtained from sources we deem reliable. While we have no doubt its accuracy, we do not guarantee it.

# GOTHARD INDUSTRIAL PARK

Industrial Units Available from 540 - 3,750 S.F.

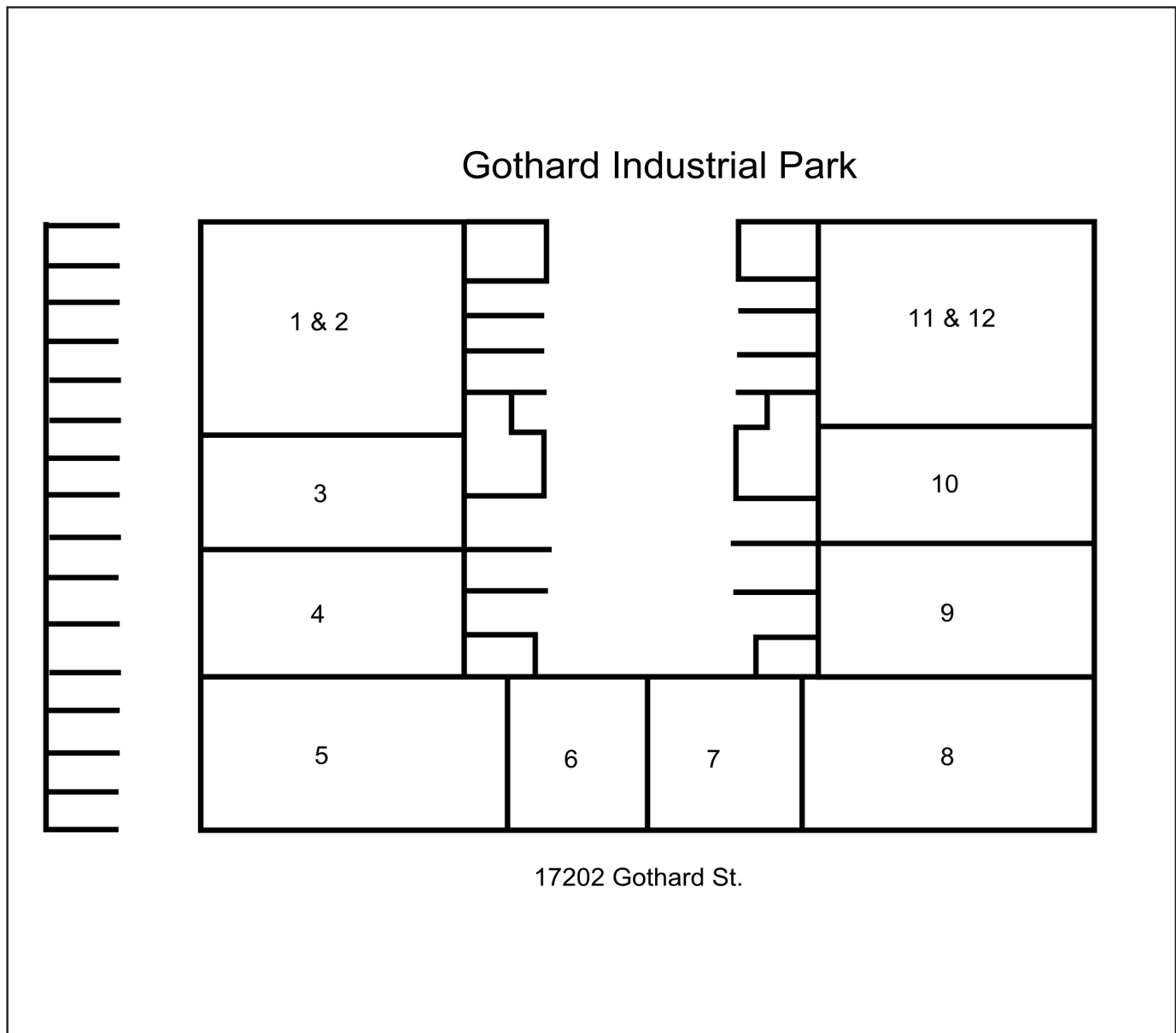

For further information, please contact:

151 Kalmus Drive, Suite F-2  
Costa Mesa, CA 92626  
714.641.1130 main  
714.641.4833 fax



The information contained herein has been obtained from sources we deem reliable. While we have no doubt its accuracy, we do not guarantee it.