

PEREZ ROAD INDUSTRIAL PARK

Retail/Industrial/Office Units Available



68703, 68713, 68733, 68743, & 68805 Perez Rd. ■ Cathedral City, CA

FEATURES

- Highly Accessible, Visible Location
- Easy Freeway Access to the 10 Fwy
- Retail/Office/Warehouse Units
- High Warehouse Ceilings
- Ground Level Truck Doors
- No CAM fees

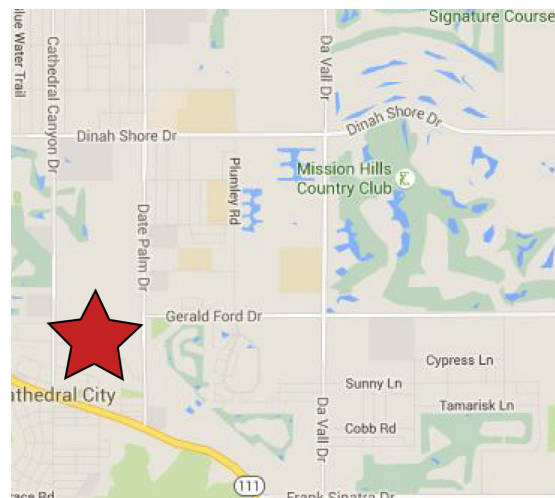

For further information, please contact:

151 Kalmus Drive, Suite F-2
Costa Mesa, CA 92626
714.641.1130 main
714. 641.4833 fax

 **FROME**
INVESTMENTS
www.fromeinc.com

The information contained herein has been obtained from sources we deem reliable. While we have no doubt its accuracy, we do not guarantee it.

PEREZ ROAD INDUSTRIAL PARK

Retail/Industrial/Office Units Available

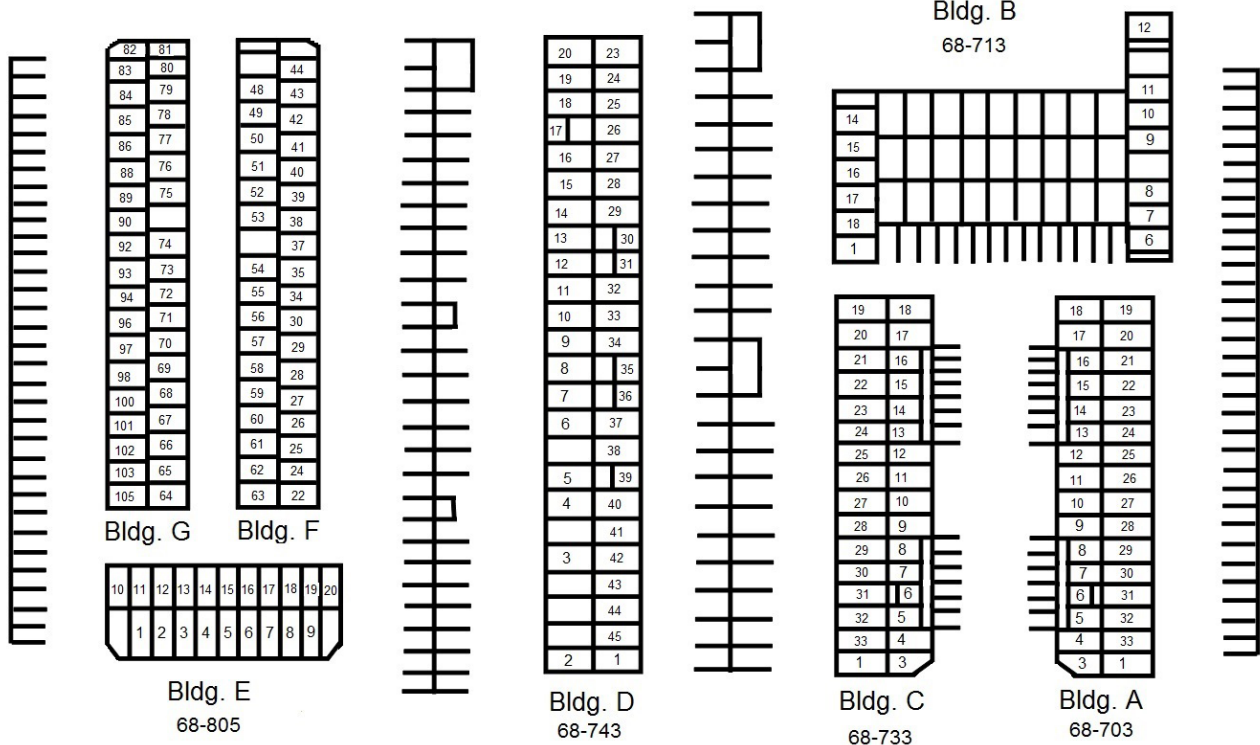

Perez Road

For further information, please contact:

151 Kalmus Drive, Suite F-2
Costa Mesa, CA 92626
714.641.1130 main
714.641.4833 fax

FROME
INVESTMENTS
www.fromeinc.com

The information contained herein has been obtained from sources we deem reliable. While we have no doubt its accuracy, we do not guarantee it.